

GIBCA

PIVOT DOORS

AUTOMATIC & MANUAL

ABOUT



Get Creative with Your Space

Gibca's Pivot Doors (Automatic & Manual) is an innovative design that creates a stunning wide and generous opening for entrances, hallways, conference and ballrooms. Its high-performance hardware allows for smooth and impressive operation of panels with ease plus safety.

We have designed and engineered two options for our Pivot doors- Manual and Automatic. Both options are a modern alternative to hinge doors and have top quality pivot bearings that make maneuvering a heavy over-sized door easy and safe. We offer a fully automatic option with a mechanism neatly mounted over pivot assembly with in-built position controls.





BENEFITS

AND ADVANTAGES

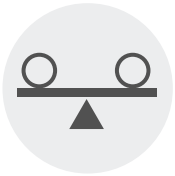

STABILITY

Strong pivot support at the base of the frame provides robust strength and stability to the solid door.



CONVENIENCE

The only door option in the market that doesn't require installing a frame. Easy pivot motion for closing and opening the door rather than a wide swinging motion.



MINIMAL CLEARANCE REQUIRED

Ideal for small spaces with minimal clearance that don't have space for an open side-hinged door.



ATTRACTIVE

Move away from mundane door designs by adding instant style with our unique pivot doors. Its unique design not only adds superior aesthetics but gives a space versatility. Open the room up or create separation in the space as needed.



SMOOTH OPERATION

Integrated hold open and soft close capability allows for smooth operation at all times.



DESIGNING FREEDOM

Pivot doors are custom-designed to meet the architectural needs of your project. Select from a vast range of colours & materials.



AUTOMATICALLY OPERATED PIVOT DOORS

Gibca's Automatic Pivot doors are a revolutionary design that allows for perfect pivot movement, giving it an ultra-smooth and outstanding performance. The speed remains constant making it a safe and even operation of the door. Ideal for creating a luxurious opening architecture where the flow of traffic needs to remain constant and uninterrupted.

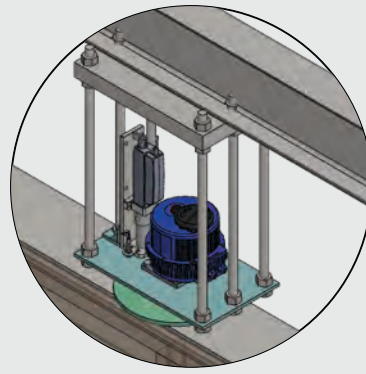

A Electrical Actuator

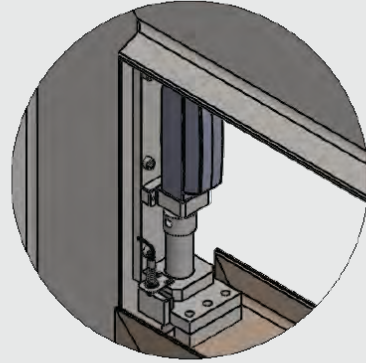

B Lock Actuator

FEATURES

- Completely sealed motor and gear unit directly mounted over pivot assembly with in-built position control. Two-position locking (open/closed) achieved a wide linear actuator locking into a custom design plate and door frame.
- Constant speed operation for safer and silent operation. Completely encased assembly eliminates hazards associated with exposed gear assemblies.
- In case of actuator failure, manual override available in this system. No need to remove the actuator.
- In-built limit switches with directly mounted gear connection have a lesser play. The use of linear actuator lock assembly eliminates any possibility of damage due to forced movements. It also ensures that the doors are firmly locked in each position.
- Electrical actuator will work 0 to 90 degree only. The system does not require mechanical end stopper for fully open and fully close positions.
- Electrical actuator has an operating voltage of 220V, 1 phase, IP 67
- Fully enclosed actuator - motor, gear and limit switches results in easier maintenance as in event of a failure, the system can be made quickly operational by just easy spare actuator replacement allowing easier fault detection and rectification for the damaged unit.
- Linear actuator lock will be concealed above ceiling.



MANUALLY OPERATED PIVOT DOORS

Gibca's Manual Pivot doors are made to measure for interior spaces with high-quality profiles where large openings are required with minimal floor space interruption. Our single-pivot door panels can be built with a greater width than a single hinged door and grouped with multiple pivot doors providing a streamlined look with smooth operation. The pins are ideally located at the top and bottom of the frame, creating an even pivot movement.

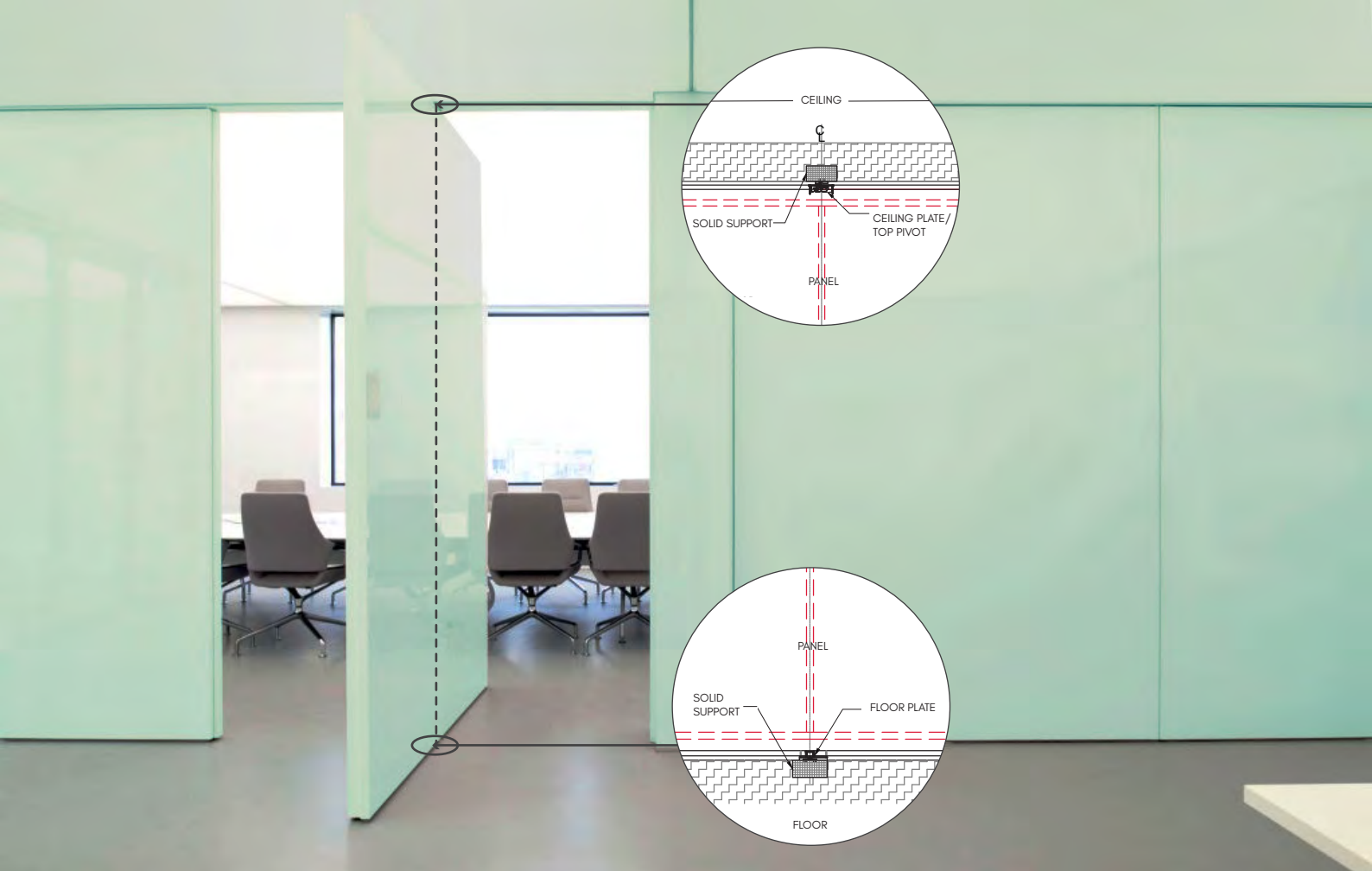

SYSTEM CONFIGURATION OPTIONS FOR MANUAL

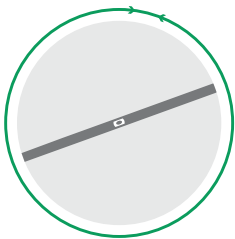

COMPACT

This system is the most compact system: the hinge acts as a revolving point.

- Rotates 360°
- No hold positions or closing function

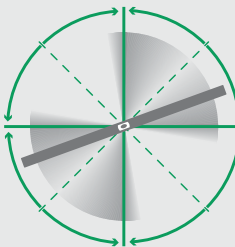

COMPACT H

This system has 3 functions: rotation, closing and holding positions. This system can turn through 360° and is characterized by a hold position at every quarter of a circle.

- Rotates 360°
- Hold positions at 0°, 90°, 180° and 270°
- Self-opening
- Self-closing

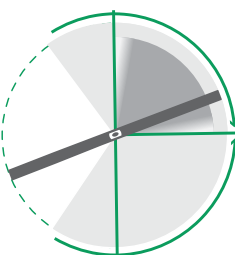

CONFIGURA

This system adds a new dimension to the pivot door by creating the ultimate smoothness: total control over the movement of the door.

- Hold positions at 0°, 90° and -90°
- Self closing from -125° and 125° - after opening
- Door can be manually set to the hold position 90° or -90°
- Adjustable closing damping (soft close)
- Adjustable hydraulic backcheck

ACOUSTIC TESTING

Gibca Pivot doors have gone through vigorous third-party acoustic testing to determine the acoustic performance. The following standard tests were conducted in a laboratory setting—ASTM E90-09 (Reapproved 2016), ASTM E413-16 and BS EN ISO 717-1-2013.

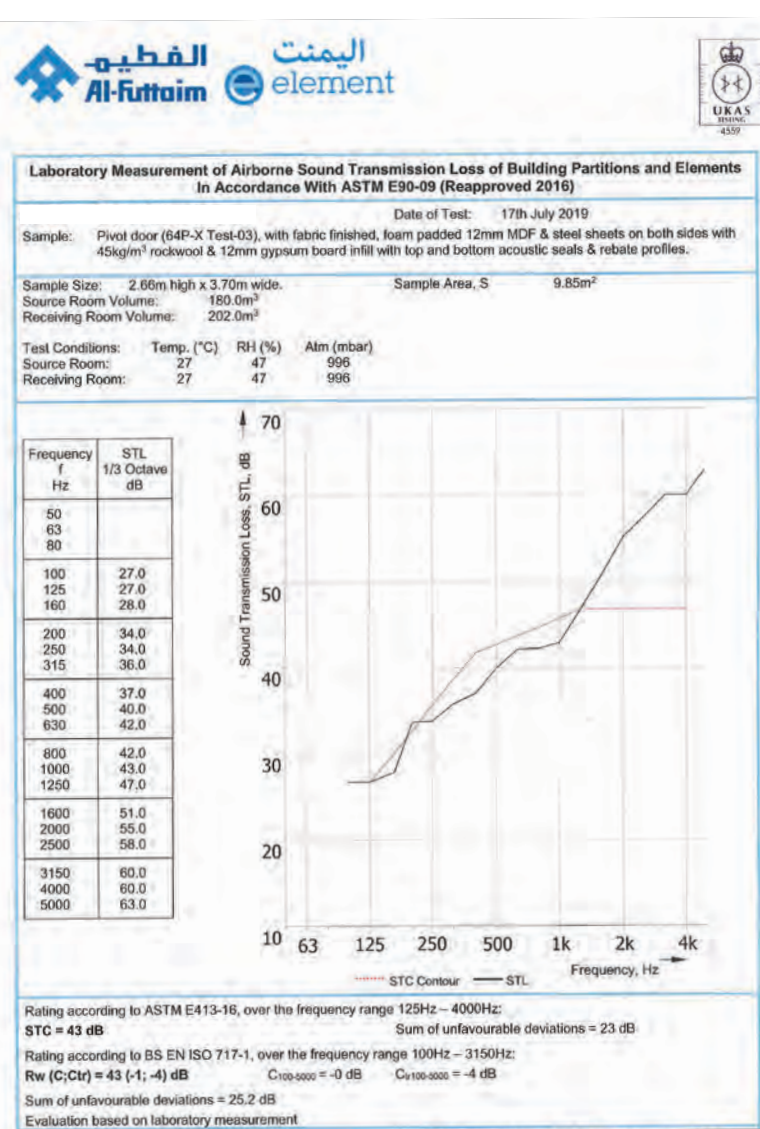
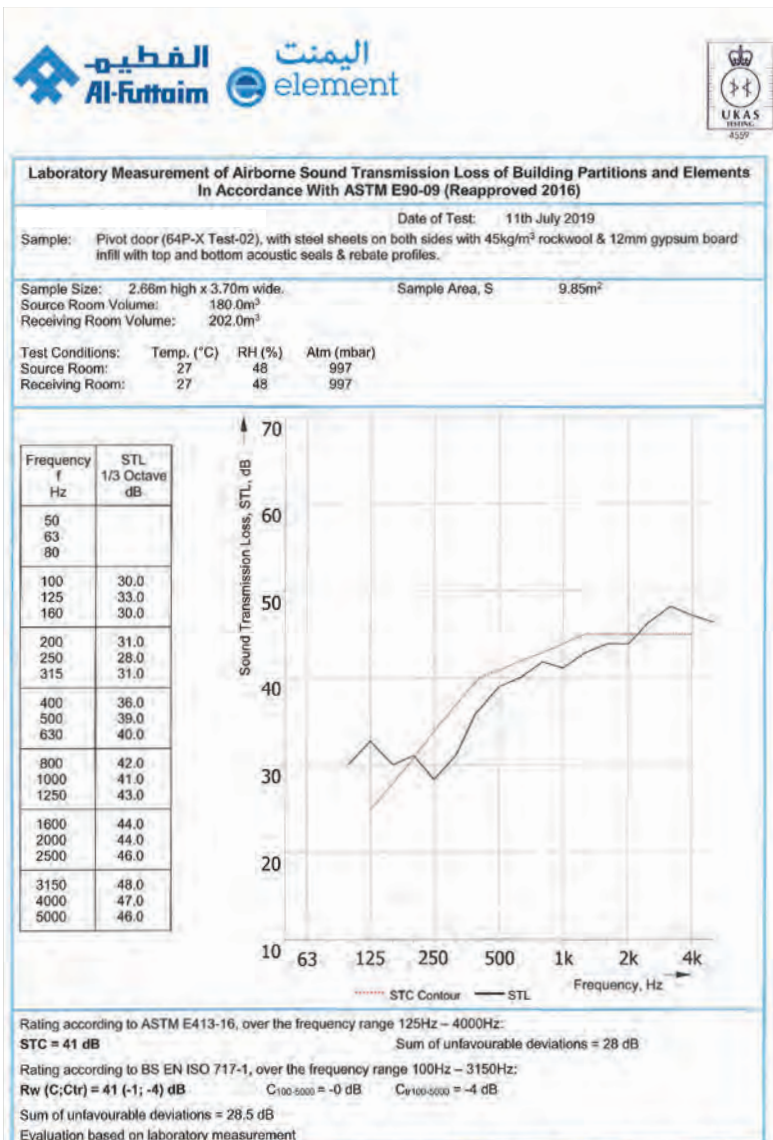



COMPARISON CHART

	AUTOMATIC	MANUAL
Rotation	0° - 90°	0° - 360°
Hold Positions	at 0° and 90°	at every 90° if system 3 is used
Frames	4" Thick Frames	3" and 4" Thick Frames
Pivot Point	Center Pivot	Center Pivot
Acoustic Rating (up to)	43 STC	43 STC
Load-bearing Capacity (up to)	800 KGS	800 KGS
Opening Time	30 seconds	Depending on operator speed
Configuration	Invisible pivot system & locking system	Invisible pivot system
Locking Mechanism	Automatic actuator locking system	Manual flush tower bolt locking at desired location



**KEEP IN
TOUCH WITH US**
We're happy to assist you.



P.O. Box: 312, Postal Code- 322, Sohar-Oman ✉ : marketing@gibcaoman.com ☎ : + 968-2-6850261 📠 : + 968-2-6850258 🌐 : www.gibcaoman.com

Follow us on: 