



642F SERIES

These rugged steel panels resist daily wear and tear and have a one-hour fire rating. They are an excellent choice for meeting rooms, heavy-use facilities, or wherever local codes require a fire rated partition.

* The local fire marshal must approve any field applied surface material.

FIREWALL PAIRED PANELS

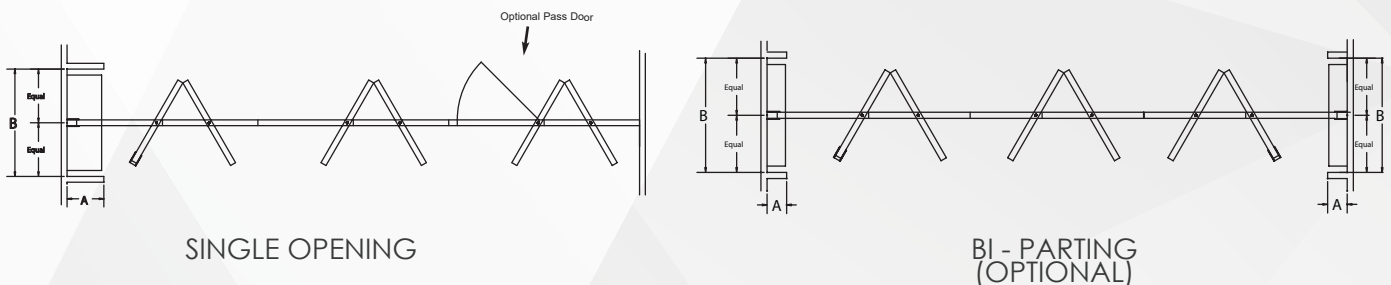

Select for wall-to-wall space division. Panels are hinged in pairs allowing fast setup. They may be stacked at either or both ends of the track or in a "pocket". One or more pair of panels may be placed anywhere along the track for use as sight dividers.

The panels are nominally 4" [101] thick and have a 16 ga. Steel welded frame. The faces may be covered from a wide selection of vinyl colors and patterns.

One Hour Fire Rated

Top Supported

Center Stack

Paired Panels

Manually Operated

Maximum Opening Height:

24'2" [7.366]

Maximum Opening Width:

Unlimited

STC Ratings: 51, 54

Available Accessories/Options

- **Pass Door Inclusion Options** – Exit signs, Automatic door closers, panic hardware, locks, frame and prep for window, peep viewer
- **Pocket Doors for Partition Storage** – factory-finished or field-finished
- **Work Surface** – Inset or full-height dry erase steel marker boards, inset porcelain enamel steel dry marker or chalkboard, eraser pocket or tack boards
- **Acoustic Baffle**

Suspension System

Track shall be of clear anodized architectural grade extruded aluminum alloy 6063-T6.

Trim Colors - standard

Available in three standard trim colors - lamb's wool, Brown or Gray. Custom colors for metal trim are also available for an additional charge.

"Standard" Product Features and Benefits:

Feature: One-hour fire rated

Benefit: Complies with local code requirements.

Feature: Fire and sound rated

Benefit: Fire protection with no loss of sound control.

Feature: One piece steel face

Benefit: Optimum acoustics; no unsightly horizontal butt joints.

Feature: No vertical trim

Benefit: Provides a monolithic look.

Feature: Quick-set retractable top & bottom seals

Benefit: Retractable seals accommodate out-of-level floor conditions; provide constant force for consistent sound control and stability when the seals are set. When retracted, nothing drags on the floor or track when the panels are moved. Panels can be "locked" in place.

Feature: Minimum 110 lb. [50 kg] seal force when seals are set.

Benefit: Maintains panel stability and optimum acoustics even on carpet or other porous floor materials.

Feature: Waist high seal activator

Benefit: Fast, easy seal activation without bending or stooping.

Feature: Removable operating handle

Benefit: Prevents unauthorized operation.

Feature: Low profile hinges

Benefit: Safety and aesthetics - no unsightly hinges protruding from the panel faces.

Feature: Expanding Jamb Closure (Lever Closure) Panel

Benefit: Exerts 250 lbs [113.4 kg] of force against the fixed wall. The compression creates tight panel joints for optimum sound control.

Feature: Interlocking vertical seal

Benefit: Helps panel-to-panel alignment and prevents sound leaks between panels.

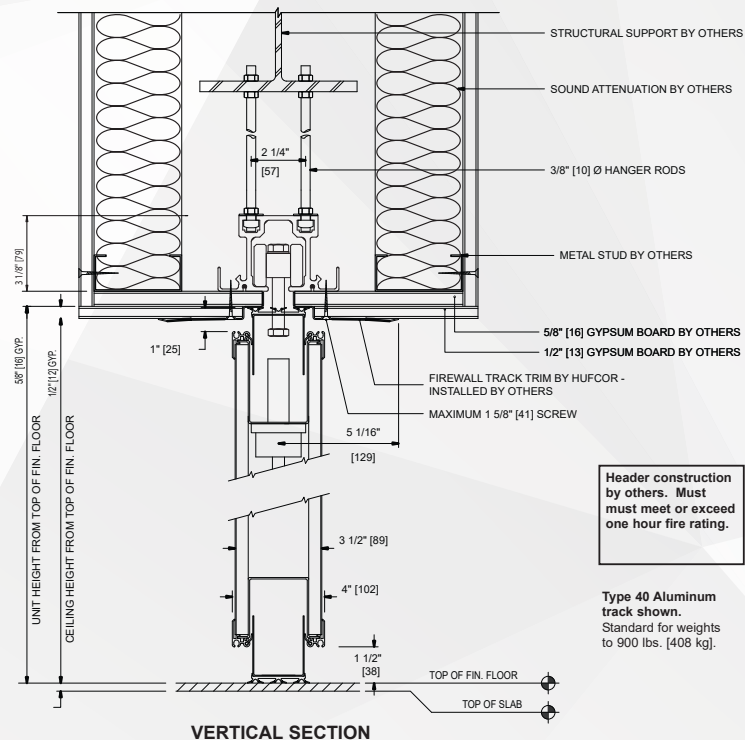

GIBCA



جیبیکا

GIBCA LIMITED COMPANY (FZC) LLC

