



GIBCA LIMITED COMPANY (FZC) LLC

COMPANY PROFILE

CERTIFICATE

ISO 14001:2015
Environment Management System

VISCOUNT QUALITY CERTIFICATIONS

M-11, Dar AL Maha Building, near Abu Hail Road, Hor AL Anz, Dubai – United Arab Emirates

This is to certify that **Gibca Limited Company (FZC) L.L.C.**

Located at **Shed #10, Al Siraj Logistics Warehouses, Sohar Free Zone, P.O. Box #312, Postal Code: 322 Sohar, Sultanate of Oman**

Has established and maintains an environmental system according to the requirements of ISO14001:2015 Environment Management System standard for:

Manufacture and Supply of Contract Furniture including Classroom Accessories, Health Club Furniture, Vanity Units, Kitchen Cabinets, Outdoor Furniture, HUF COR Operable Partitions, Skyfold Automatic Folding Partitions, Office Partitions and Bi-Fold Partitions.

This certificate is based on IAF EA/NACE codes 23 / 31 and result of an Environment management system audit documented in the audit report VQC/032/Q&E-stage2/1218.

Certificate number: 19 EMS 026-1
Valid from 30 January 2019 to 29 January 2022.

Further clarifications regarding the scope of this certificate and the applicability of ISO14001:2015 requirements may be obtained by consulting the organization.

This certificate is granted during the technical review on 30 January 2019 and is subject to the General Regulation of Viscount.



Signed for the certification body:

General Manager



CB-076-MS/1

TD-04-03/May2018

CERTIFICATE

ISO 9001:2015
Quality Management System

VISCOUNT QUALITY CERTIFICATIONS

M-11, Dar AL Maha Building, near Abu Hail Road, Hor AL Anz, Dubai – United Arab Emirates

This is to certify that **Gibca Limited Company (FZC) L.L.C**

Located at **Shed #10, Al Siraj Logistics Warehouses, Sohar Free Zone, P.O. Box #312, Postal Code: 322 Sohar, Sultanate of Oman**

Has established and maintains a quality system according to the requirements of ISO 9001:2015 Quality Management System standard for:

Manufacture and Supply of Contract Furniture including Classroom Accessories, Health Club Furniture, Vanity Units, Kitchen Cabinets, Outdoor Furniture, HUF COR Operable Partitions, Skyfold Automatic Folding Partitions, Office Partitions and Bi-Fold Partitions.

This certificate is based on IAF EA/NACE codes 23 / 31 and result of a quality management system audit documented in the audit report VQC/032/Q&E-stage2/1218.

Certificate number: 19 QMS 027-1
Valid from 30 January 2019 to 29 January 2022.

Further clarifications regarding the scope of this certificate and the applicability of ISO 9001:2015 requirements may be obtained by consulting the organization.

This certificate is granted during the technical review on 30 January 2019 and is subject to the General Regulation of Viscount.



Signed for the certification body:

General Manager



CB-076-MS/1

TD-04-03/May2018

Gibca Limited Company (FZC) LLC

which is a part of GIBCA Group has been long recognized as one of the leading manufacturers and suppliers of contract furnishings.

Since Gibca's establishment, it's defining features are its quality and potential to innovate. Trusted by architects and contractors worldwide, Gibca has made over 50,000 installations spanning Middle East, Central Asia, and North Africa.

All our products help exploit to the fullest the potential that every space offers. Our state-of-the-art manufacturing facility and an extremely talented technical team turn out a wide range of custom-made products that affirm our reputation for expertly engineering design and top-quality workmanship. We seek to provide each of our customer's with highly personalized service right from design to after sales.

Our goal is simple - we help you manage your space better!



Over 50,000
Projects



Over 5,000
Satisfied Clients Globally



350 Plus Workforce
Working For You



25 Years
Of Experience



OUR MISSION

To be a leading provider of high-quality space management solutions and services that provide strategic value to our customers.

To provide unsurpassed customer service to our clients; Service is the heart of our business.

To create a culture that values and supports employee engagement, encourages personal development, and fosters team collaboration.

To be a trusted and valued resource in the industry for experts and specialists.

We believe all built environments and their occupants can benefit from intelligent sustainable design irrespective of acquired certifications.

In close collaboration with our principals and suppliers, we strive to create an environment that will enhance the structure and lines of interior space.

To be committed to our global responsibility of environmental care by manufacturing products that meet our standard of sustainability.



VISION

OUR VISION

To be a leading and trusted provider of custom-designed space management solutions in the region by providing world-class manufacturing of premium quality products and superior customer service.

THE GIBCA RANGE OF PRODUCTS

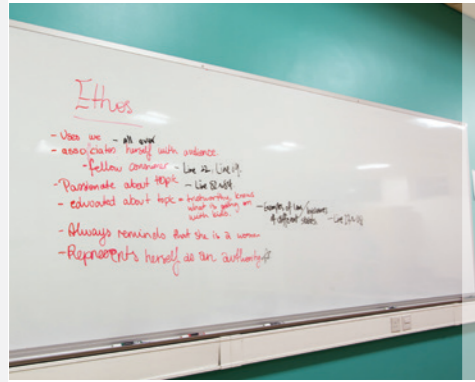

COMPACT LAMINATE SOLUTIONS - INTERIOR APPLICATIONS



COMPACT LAMINATE SOLUTIONS - EXTERIOR APPLICATIONS



OFFICE PARTITION SYSTEMS



AUTOMATIC HYDRAULIFT ARCHITECTURAL DOORS & WINDOWS*



ACOUSTIC OPERABLE & GLASS PARTITIONS (HORIZONTAL FOLDING)*



PIVOT DOORS*



VERTICAL LIFT WALLS*

* Gibca has qualified personnel that are authorized to perform any type of maintenance work and we offer an extensive selection of service and maintenance options to enhance your experience with our products.

COMPANY PROFILE

PRODUCT RANGE

CAPABILITIES & NETWORK

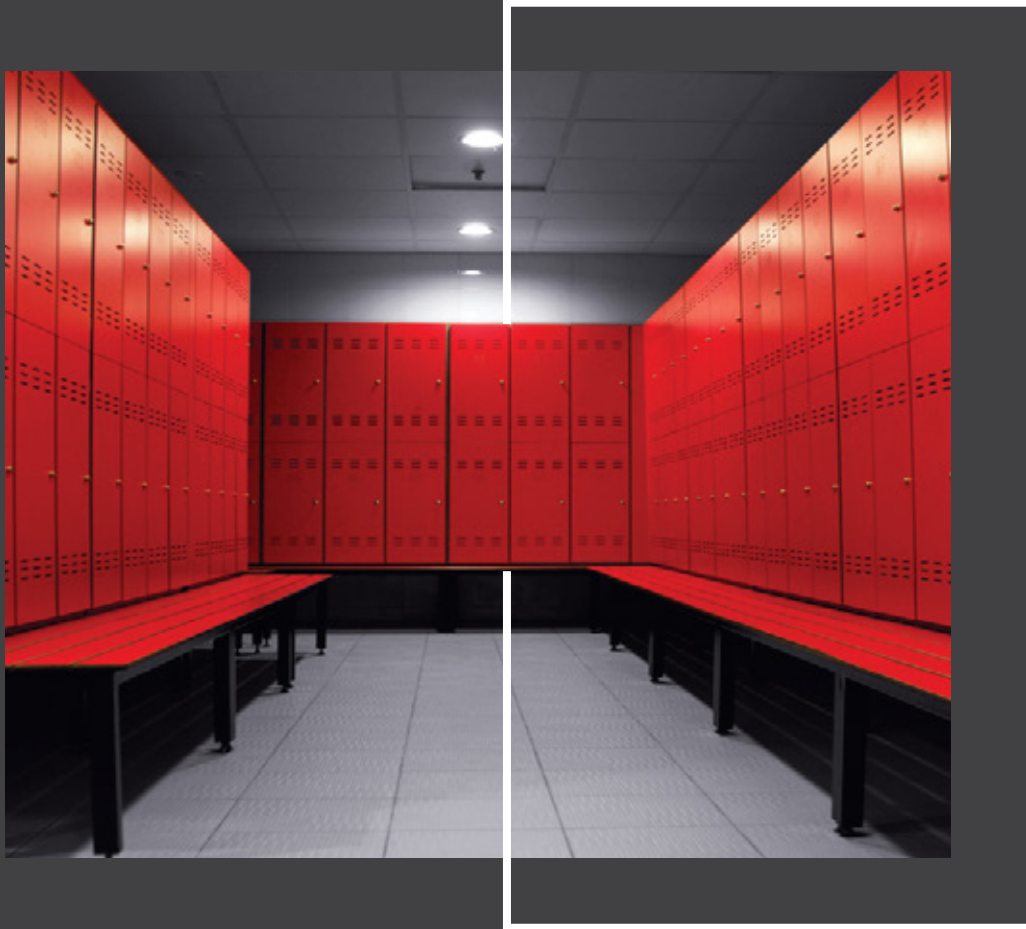

COMPACT LAMINATE SOLUTIONS



THE COMPLETE WASHROOM SOLUTIONS

WASHROOM CUBICLES



COMPLETED PROJECTS

- Muscat International Airport, Oman
- The Wave Muscat Golf Course, Oman
- Mesaieed Elementary & Senior School, Qatar
- Qatar Faculty of Islamic Studies, Qatar
- The Wave Muscat Village, Oman
- Hamad Bin Khalifa Medical City, Qatar
- Sundus Rotana Hotel, Oman
- Lusail Sports Club, Qatar
- Qatar Islamic Bank, Qatar
- Doha Festival City, Qatar
- Musandam Gas Plant, Oman
- Qatar Foundational Central Library, Qatar
- Lusail Tower, Qatar
- Al Sadd Sports Club, Qatar
- Gabbro Terminal, Qatar



LOCKER SYSTEMS



COMPLETED PROJECTS

- Hamad International Airport, Qatar
- Mall of Qatar, Qatar
- Kempinski Hotel and Hotel Apartment -The Wave, Oman
- National Security Shield, Qatar
- Al Ahli Sports Club, Qatar
- Qatar University - New College of Engineering, Qatar
- Sheraton Doha Hotel and Resort, Qatar
- Qatar Fertilizer Company(QAFCO), Qatar
- Woqod Depot Extension, Qatar
- Al Gharafa Sports Club, Qatar
- Sumaisma & Barzan Center, Qatar
- Lusail Shooting Complex, Qatar
- ABM Military College, Qatar
- Bin Samikh Tower, Qatar
- Msheireb Downtown, Qatar



INTERNAL WALL CLADDING



EDUCATION & PRESENTATION AIDS



INTEGRATED PANEL SYSTEMS

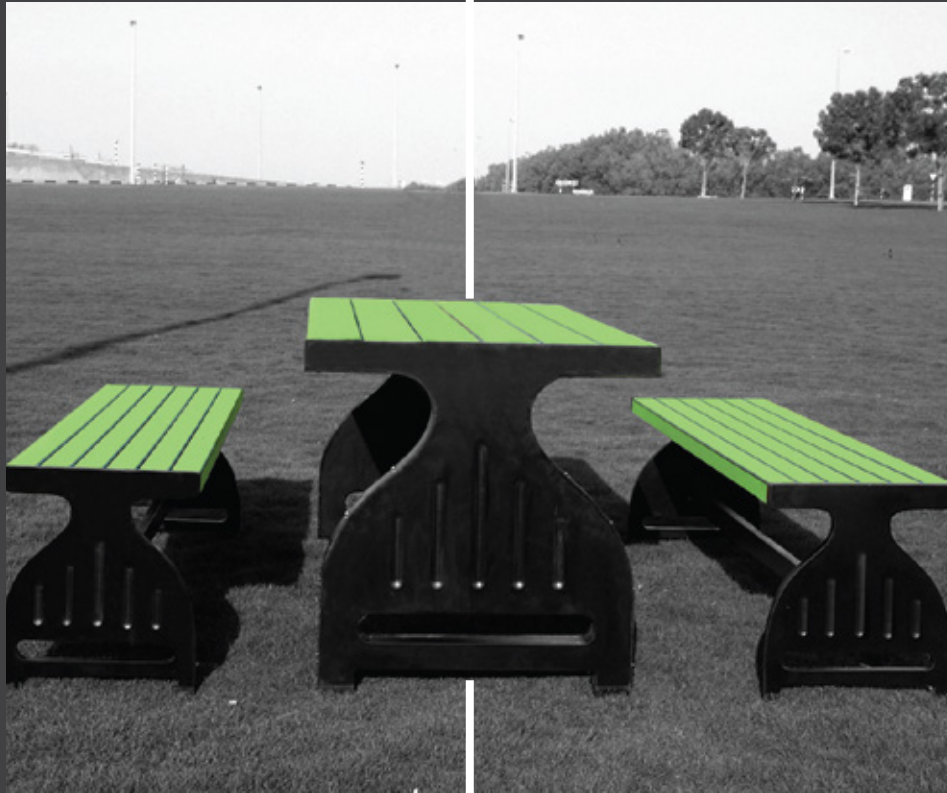

EXTERIOR APPLICATIONS





OFFICE PARTITION SYSTEMS



COMPLETED PROJECTS

- Aspire Academy Football Performance Center, Qatar
- Ministry of Interior, Qatar
- Muscat International Airport - MC4A Civil Aviation HQ, Oman
- Public Authority for Social Insurance (PASI) HQ, Oman
- Al Hitmi Office, Qatar
- Oman Oil Refineries and Petroleum Industries Company, Oman
- Tornado Tower, Qatar
- Public Authority for Civil Aviation (PACA) – HQ, Oman

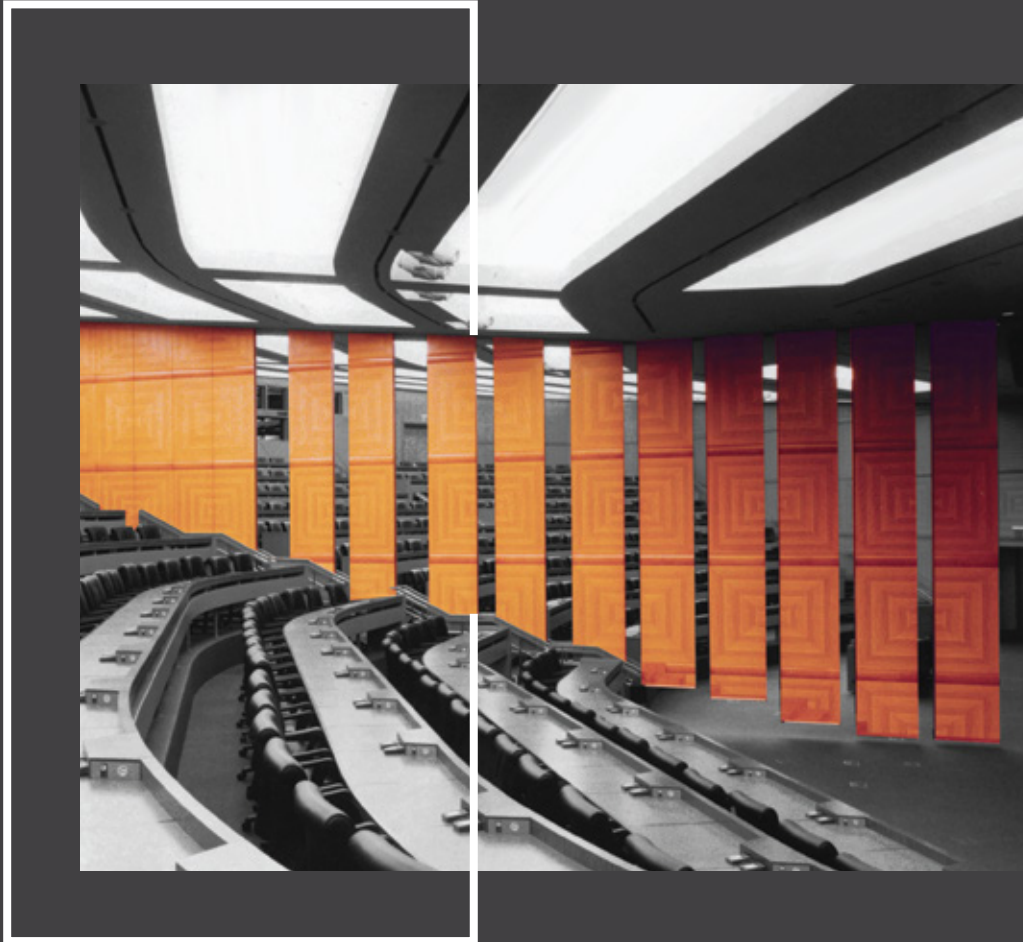

**ACOUSTIC OPERABLE & GLASS
PARTITIONS (HORIZONTALLY FOLDING)**



ACOUSTIC OPERABLE WALLS



COMPLETED PROJECTS

- Doha Exhibition & Convention Center, Qatar
- Sheraton Hotel, Oman
- Lusail Marina Tower, Qatar
- Regent Hotel, Qatar
- Doha Women's Club, Qatar
- Falcon Tower – Ballroom, Qatar
- Remal Castle Building Bausher, Oman
- Sidra Medical Center, Qatar
- Arjaan Hotel, Oman
- Holiday Inn, Qatar
- Khalifa Stadium & Museum at Aspire Zone, Qatar
- Muscat International Airport, Oman
- Golden Tulip Hotel, Oman
- Chamber of Commerce, Qatar
- Oman Tourism & Hospitality Academy, Oman



ACOUSTIC GLASS PARTITIONS



COMPLETED PROJECTS

Muscat International Airport MC3, Oman
Hilton Hotel, Qatar
Bank Muscat, Oman
Dukhan Hospital, Qatar
The Pearl, Qatar
Canadian Embassy, Qatar
Advanced Tourism Investment Company, Qatar
ADIB Bank, Qatar
Rosha Supermarket & Shopping Mall, Iran
La Cigale Hotel, Qatar
Mercedes Benz Showroom & Office, Qatar
Cruise Terminal Building, Oman
Falcon Tower, Qatar
Teatro Restaurant - City Centre Rotana, Qatar



**AUTOMATIC HYDRAULIFT
ARCHITECTURAL DOORS & WINDOWS**

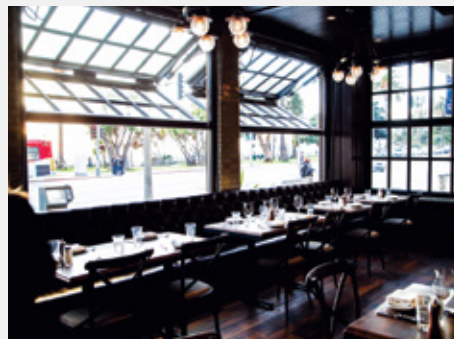

COMPANY PROFILE

PRODUCT RANGE

CAPABILITIES & NETWORK

SERVICE AND MAINTENANCE



FREE FIRST-TIME
PARTITION INSPECTION

Gibca offers an extensive selection of Service & Maintenance options to enhance your experience with our products. Choose from a wide range of customized maintenance packages to meet your specific needs.

Preventive Maintenance

Recovering Services

Emergency Repair Services

Retrofit Options Available

SERVICE AND MAINTENANCE PROGRAM

- Triannual Services - 3 Maintenance Services Annually
- Half Yearly Services - 2 Maintenance Services Annually
- Annual Services - 1 Maintenance Service Annually



GENERAL

- Adjusting all panels, pass doors and pocket doors to a plumb condition.
- Lubricating all trolleys, hinges, and other moving parts.
- Track cleaning and lubricating.
- Checking all panels, alignment, leveling and face finishes.
- Checking electric motors, switches, and drive components.
- Staff training provided for partitions operation and basic maintenance.



FINISHES

- Finish changes for worn or scuffed operable panels.
- Offering largest inventory of designer wall coverings to choose from: carpet, vinyl, fabric, laminate, wood, steel, glass, mural, and paint.
- Smooth-out cosmetic and surface damage.



REPLACEMENT AND RECONDITIONING

- Manufacturing outdated parts to keep your current operable walls in an excellent working condition.
- Replacement of seals and activation hardware.
- Reconditioning of trolleys, track, intersections, and switches.



REFURBISHMENT

- Demolishing and replacement of old partitions.
- Repair and adjust to factory specification.
- Relocation and rerouting of existing operable walls.
- Partition and track replacement.



ACOUSTIC

- Securing loose acoustic seals.
- Improve the soundproofing of partition walls and building envelope.

OUR VISION IS TO BE A LEADER
IN THE INDUSTRY FOR THE
REGION AND BEYOND.

A THANK YOU TO ALL OUR
INTERNATIONAL PARTNERS
FOR THEIR ASSISTANCE IN
MAKING OUR PRESENCE
FELT AROUND THE WORLD

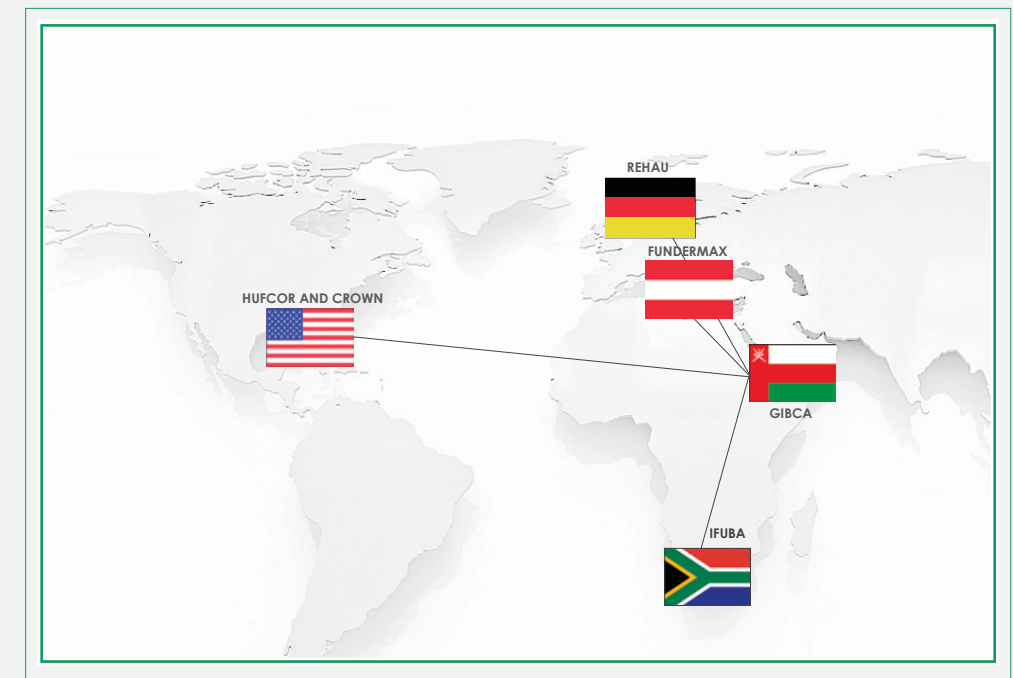

TECHNICAL RESOURCE PARTNERSHIP



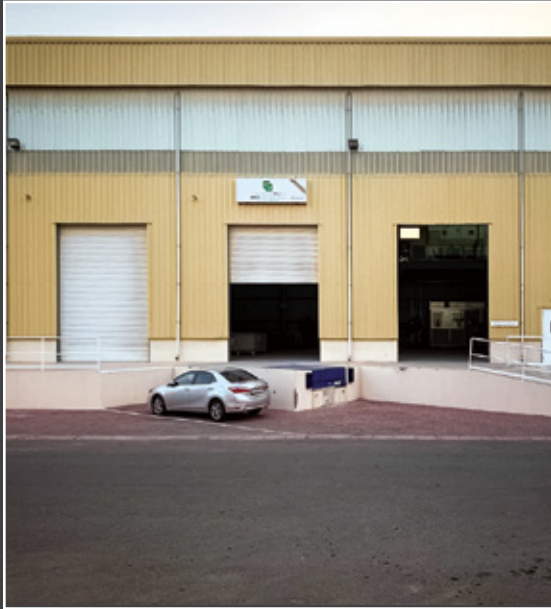

CUSTOMER FOCUS VALUES
AND CUTTING EDGE TECHNOLOGY PROPELS
OUR GROWTH AND LEADERSHIP IN THE MARKET



TANWEER FAROOQI
General Manager

Gibca Limited Company prides itself in being a customer-centric and customer-driven company. Client needs and requirements determine our path. We have a highly skilled, dynamic and competent team of top professionals forming the backbone of our operations. A team trained to succeed today and excel at tomorrow's challenges.

We are all about perfection — By making technical data and inputs available to architects, consultants, and designers, evaluating site requirements, customize manufacturing in keeping with stringent international standards, efficient installation, and post-sales care — *We take care of it all.*

WE SERVE SEVERAL MARKET SEGMENTS OFFERING THEM PREMIUM PRODUCTS, QUALITY SERVICE AND AN EXCEPTIONAL CUSTOMER SERVICE EXPERIENCE



| | HOTELS & RESIDENCES | BANKS, OFFICES, PUBLIC BUILDINGS & GOVERNMENT SECTORS | CONVENTION CENTERS | AIRPORTS | METRO & RAIL | HOSPITALS & CLINICS | EDUCATIONAL SECTORS | RETAIL & LEISURE CENTERS | SPORTS COMPLEXES | LEISURE PARKS |
|---|---------------------|---|--------------------|----------|--------------|---------------------|---------------------|--------------------------|------------------|---------------|
| ACOUSTIC MOVABLE WALLS | | | | | | | | | | |
| HORIZONTAL | ✓ | ✓ | ✓ | ✓ | ✓ | ✓ | ✓ | ✓ | ✓ | ✓ |
| GLASS WALLS | ✓ | ✓ | ✓ | ✓ | ✓ | ✓ | ✓ | ✓ | ✓ | ✓ |
| AUTOMATIC HYDRAULIFT DOORS & WINDOWS | ✓ | ✓ | ✓ | | | | | | | |
| OFFICE PARTITIONS | ✓ | ✓ | ✓ | ✓ | ✓ | ✓ | ✓ | ✓ | ✓ | ✓ |
| HPL COMPACT LAMINATE SOLUTIONS | | | | | | | | | | |
| INTERIOR APPLICATIONS | | | | | | | | | | |
| WASHROOM CUBICLES | ✓ | ✓ | ✓ | ✓ | ✓ | ✓ | ✓ | ✓ | ✓ | ✓ |
| INTEGRATED PANELS | ✓ | ✓ | ✓ | ✓ | ✓ | ✓ | ✓ | ✓ | ✓ | ✓ |
| VANITY UNITS | ✓ | ✓ | ✓ | ✓ | ✓ | ✓ | ✓ | ✓ | ✓ | ✓ |
| LOCKERS | ✓ | ✓ | ✓ | ✓ | ✓ | ✓ | ✓ | ✓ | ✓ | ✓ |
| WALL CLADDING | ✓ | ✓ | ✓ | ✓ | ✓ | ✓ | ✓ | ✓ | ✓ | ✓ |
| EDUCATION & PRESENTATION AIDS | | | | | | | | | | |
| MAGNETIC, TACK, AND DRY MARKER BOARDS | | ✓ | | | | | ✓ | | | |
| CLASSROOM FURNITURE | | | | | | | ✓ | | | |
| EXTERIOR APPLICATIONS | | | | | | | | | | ✓ |

COMPANY PROFILE

PRODUCT RANGE

CAPABILITIES & NETWORK

SOME OF THE MOST ICONIC PROJECTS

CONVENTION CENTERS

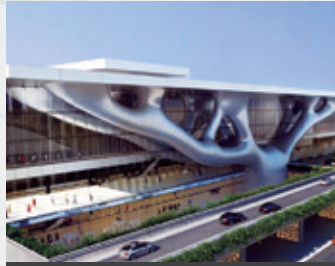

QATAR NATIONAL CONVENTION CENTER



OMAN EXHIBITION & CONVENTION CENTER

AIRPORTS



HAMAD INTERNATIONAL AIRPORT



MUSCAT INTERNATIONAL AIRPORT

HOTELS



FOUR SEASONS HOTEL



GRAND HYATT HOTEL



SHERATON DOHA HOTEL AND RESORTS



KEMPINSKI HOTEL & APARTMENT

SCHOOLS



MESAIIED ELEMENTARY & SENIOR SCHOOL



NEW COLLEGE OF ENGINEERING QATAR UNIVERSITY



VIRGINIA COMMONWEALTH UNIVERSITY



WEILL CORNELL MEDICAL COLLEGE

MALLS & LEISURE



DOHA FESTIVAL CITY



MALL OF QATAR



AL KHOR PARK



AL RAYYAN PUBLIC PARK

HOSPITALS & CLINICS



HAMAD BIN KHALIFA MEDICAL CITY



NAUFAR REHABILITATION CENTER



SIDRA MEDICAL & RESEARCH CENTER



DUKHAN HOSPITAL

BANKS, OFFICES, PUBLIC BUILDINGS AND GOVERNMENT SECTORS



PUBLIC AUTHORITY FOR CIVIL AVIATION



AL HITMI OFFICE



MUSEUM OF ISLAMIC ARTS

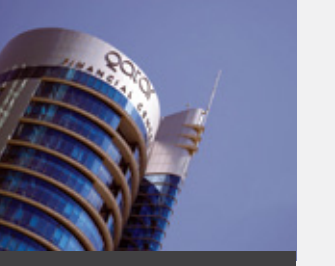

QATAR FINANCIAL CENTER

SPORTS COMPLEXES



ASPIRE ACADEMY



KHALIFA INTERNATIONAL STADIUM



QATAR RACING & EQUESTRIAN CLUB



AL AHLI SPORTS CLUB

THINK SPACE
MANAGEMENT

THINK GIBCA



**OUR
COMMITMENT**

In today's pursuit of innovation and excellence, we collaborate with designers to create revolutionary structures that enhance our environment for today and for future generations. We are socially-conscious not to detract from energy consumption or resource depletion. We have worked diligently over the years and continue to do so when selecting our suppliers, production process and products so that they meet our standard of sustainability and leave a smaller footprint on the world.



GIBCA
Compact Laminate Solutions

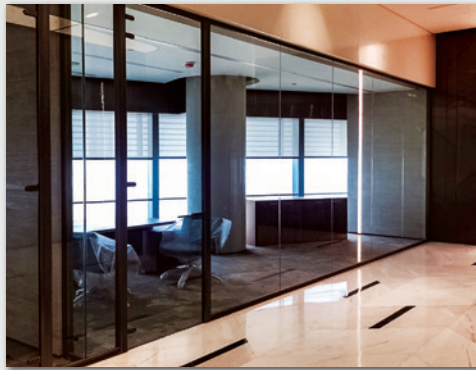

GIBCA
Office Partition Systems



GIBCA
Pivot Doors



HUFCOR
Acoustic Operable & Glass Partitions
(Horizontally Folding)



CROWN
Automatic Hydraulic Architectural
Doors & Windows

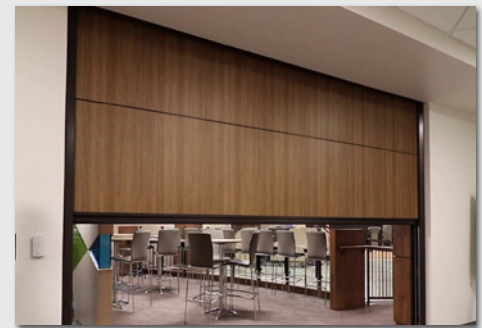

HUFCOR
Vertical Lift Walls

